

File: MC_DroughtNotes.pdf For residents use taking notes, coloring, whatever.
Of six original Menlo Commons plot plan drawings, this is the least cluttered one.
This page is the same as MC_landscape_overview.pdf, page 3, slightly enlarged.
The six plot plan drawings are (1) Plumbing, (47) Electrical, (56) Plumbing phase I,
(63) Landscape construction, (64) Irrigation (this one) and (65) Planting.
The big fat line separates Phase I, Bldgs A & B, from Phase II, Bldgs C, D, & E.

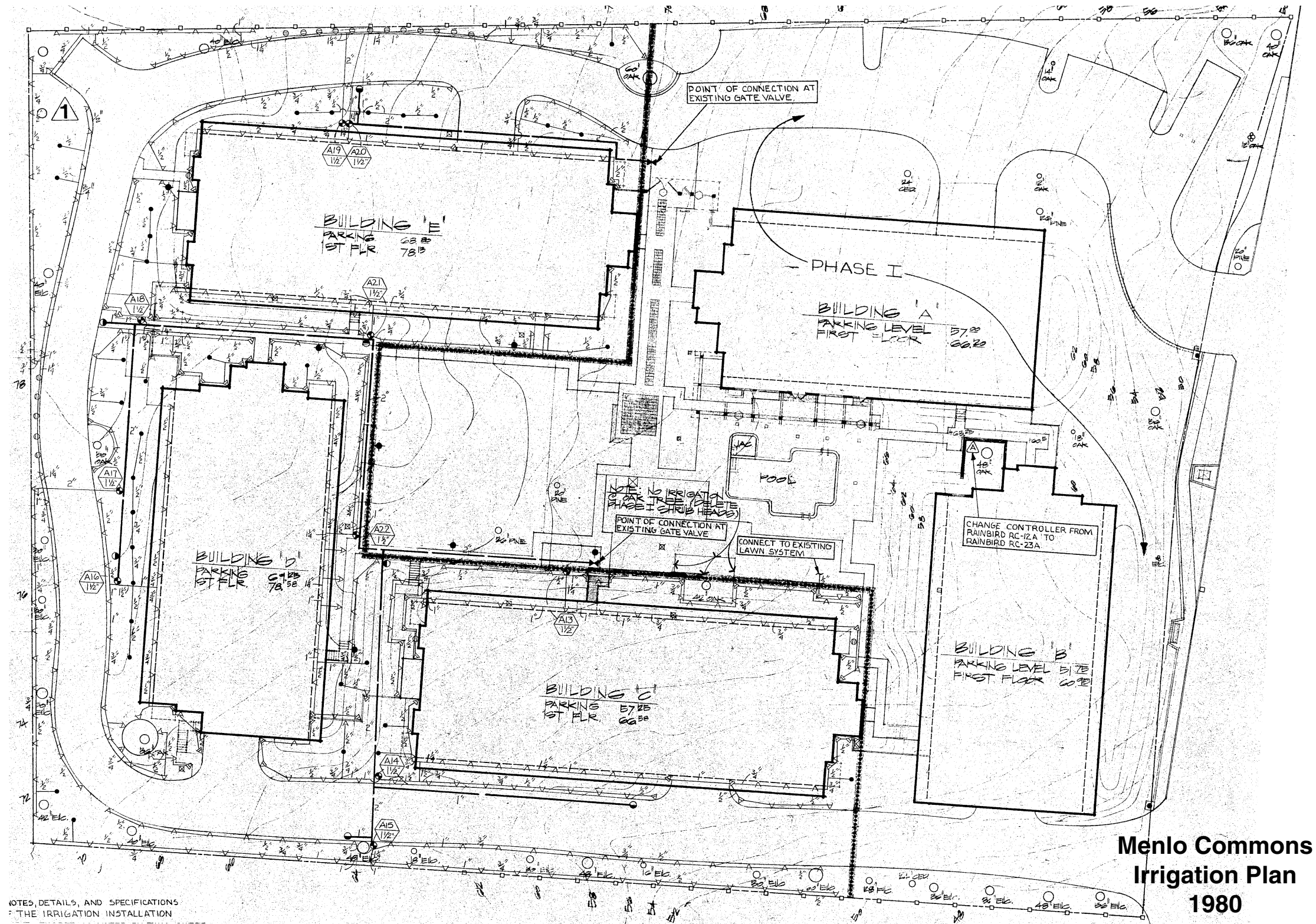

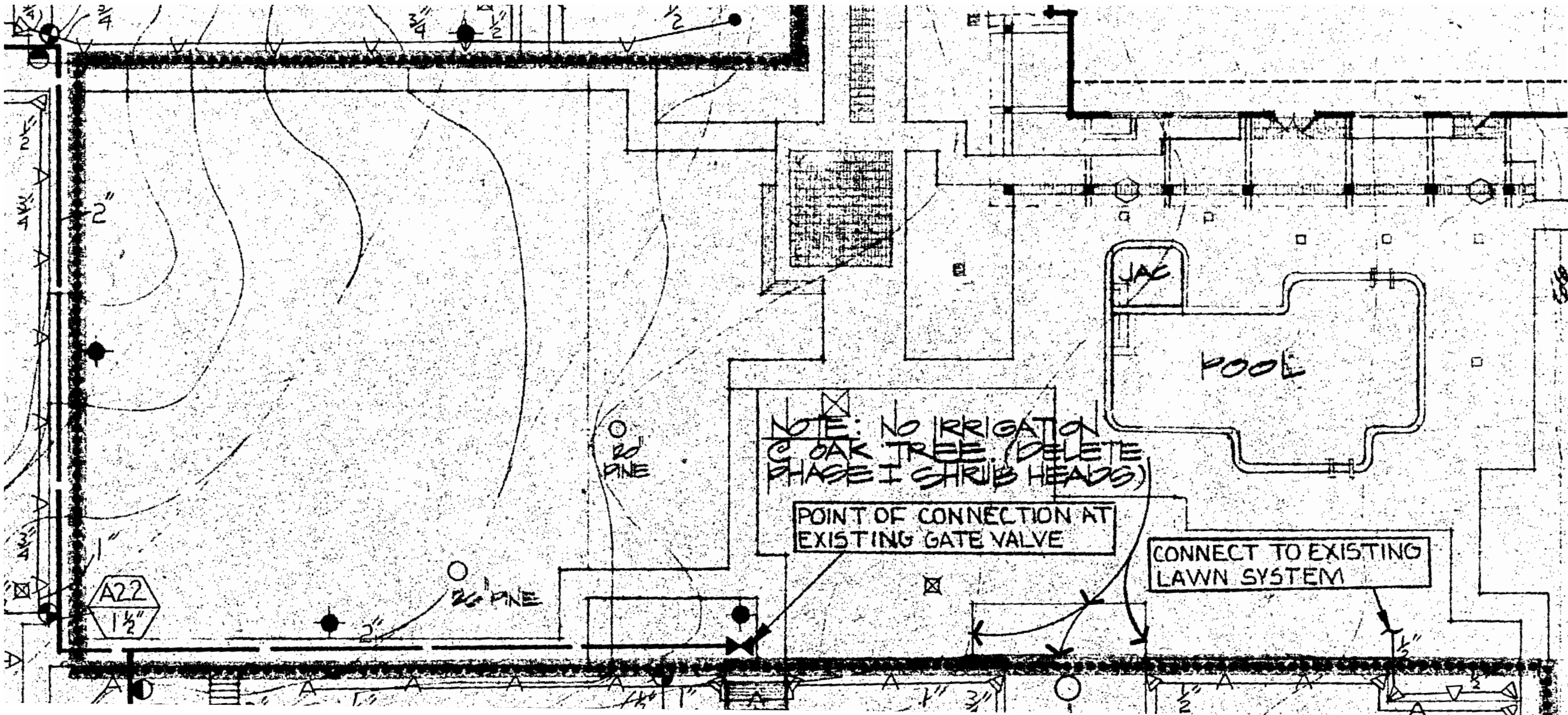

NOTE: NO IRRIGATION @ OAK TREE (DELETE PHASE I SHRUB HEADS)

POINT OF CONNECTION AT EXISTING GATE VALVE

CONNECT TO EXISTING LAWN SYSTEM

A22
1 1/2"

O
RD
PINE

O
RD
PINE

JAC

POOL

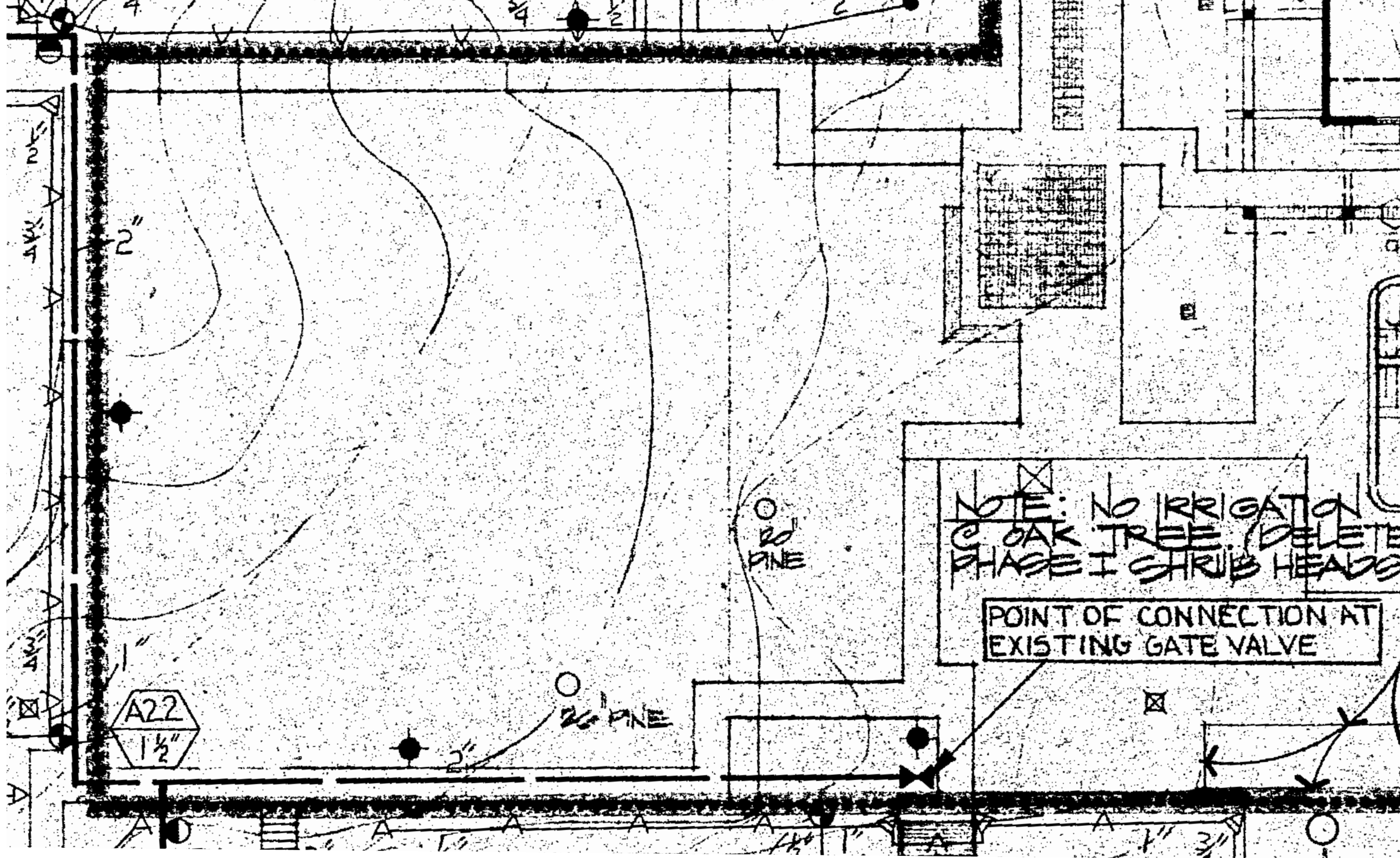

NOTE: NO IRRIGATION
W/ OAK TREES. DELETE
PHASE I SHRUB HEADS

POINT OF CONNECTION AT
EXISTING GATE VALVE

A22
1 1/2"

2" PINE

2 1/2" PINE

4"
2"

1"

2"

