

05: Spaces, bird's eye view



Picture from Google Satellite, with some key dimensions in white.

Also, 12 foot dia tree root spreads show in green with green dimension arrows and lettering.



This illustration shows only one possible implementation. 35 foot dia plaza, three 12 foot dia meeting places. Walkways. _Ping Pong and Bocce ball. All green grass areas replaced with drought resistant, colorful greenery.

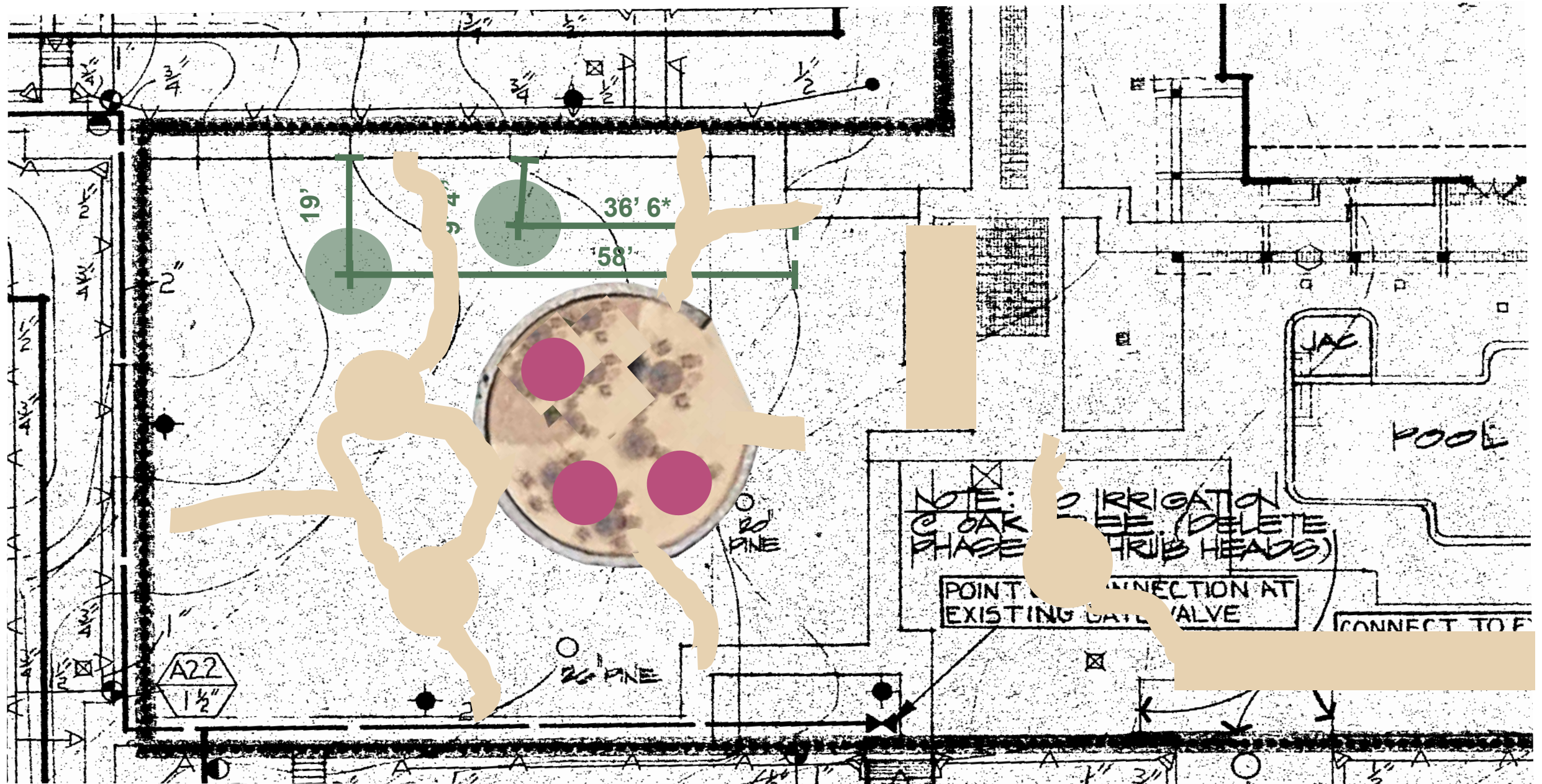

Features from the previous slide superimposed on our drawing. Countours indicate two foot elevation changes. With the plaza aligned with our gazebo's level we will have to recess it about 3½ feet into the hillside at the Bldg D end. The wall you can sit on will serve as a partial retaining wall. With some mounds and plants all around, this will make for a cozy oasis.

How big is 35 feet?

While I was new to MC, I saw an opportunity to expand on the entry way. Here is a layout I created, to scale.

Only later, as I discussed this idea with others, did I learn that Hal Harbatkin had proposed the very same concept.

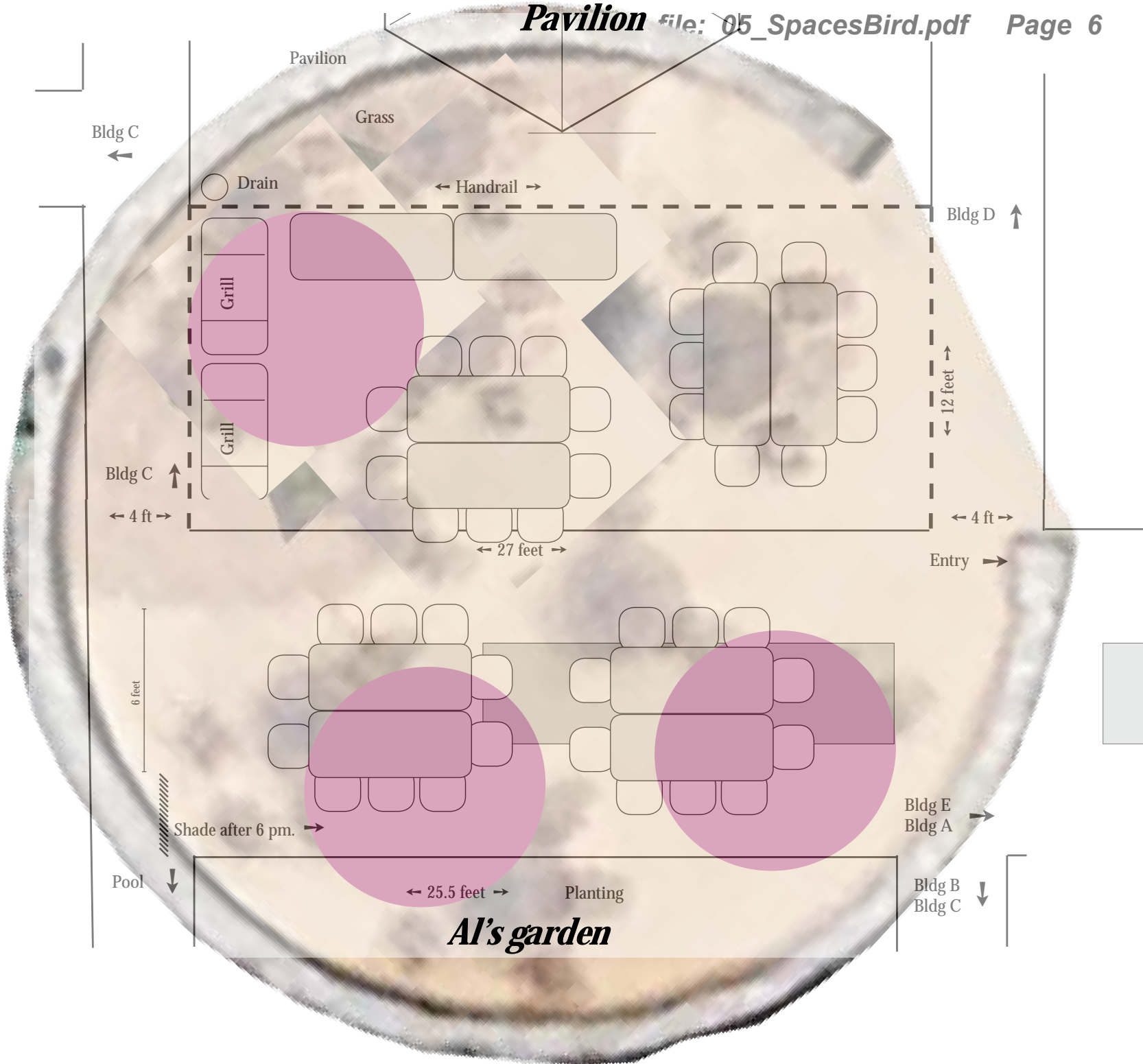

How big is 35 feet?

Here is a stretch unit compared to the plaza

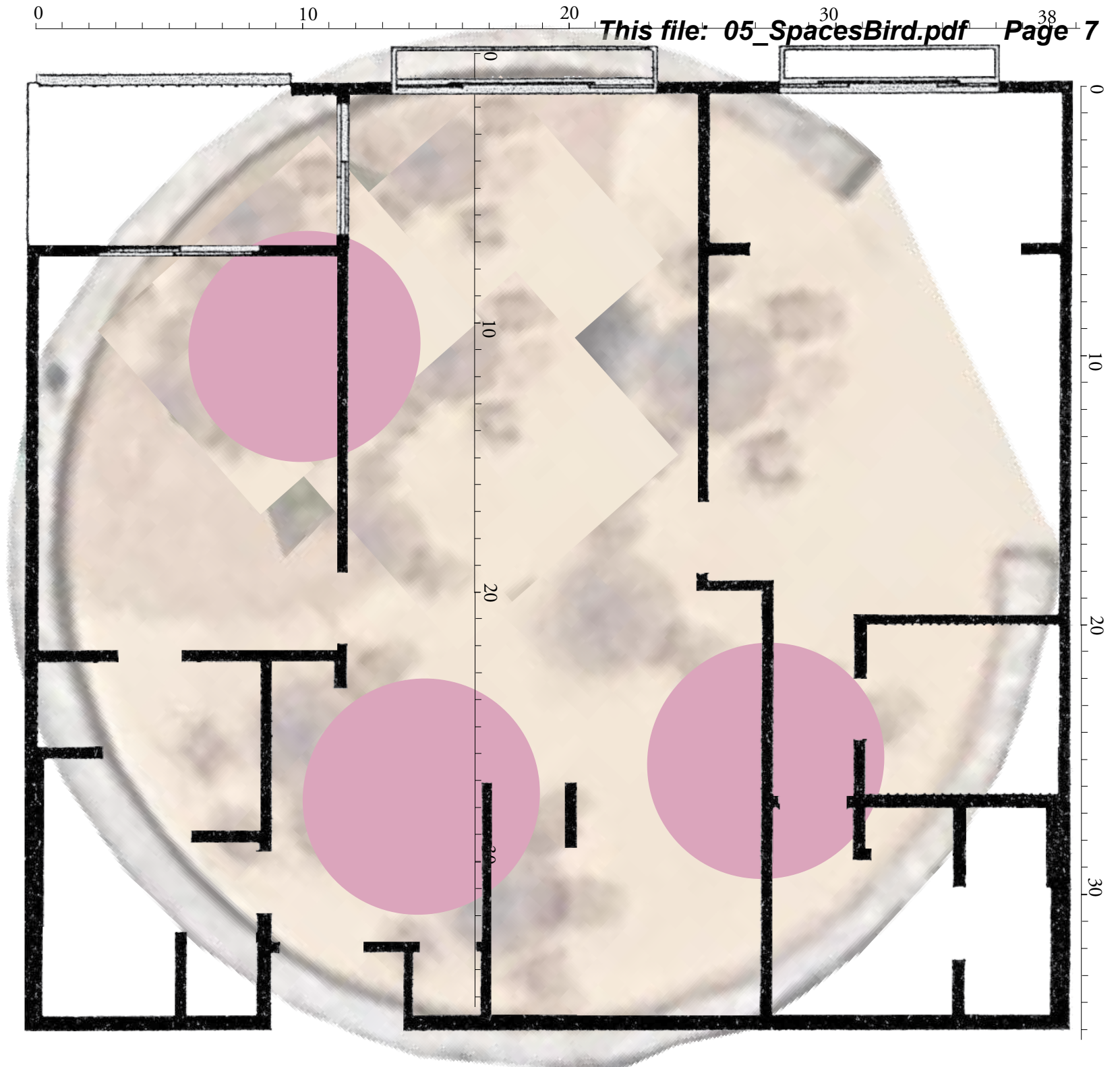

How big is 35 feet?

Here is an end unit compared to the plaza

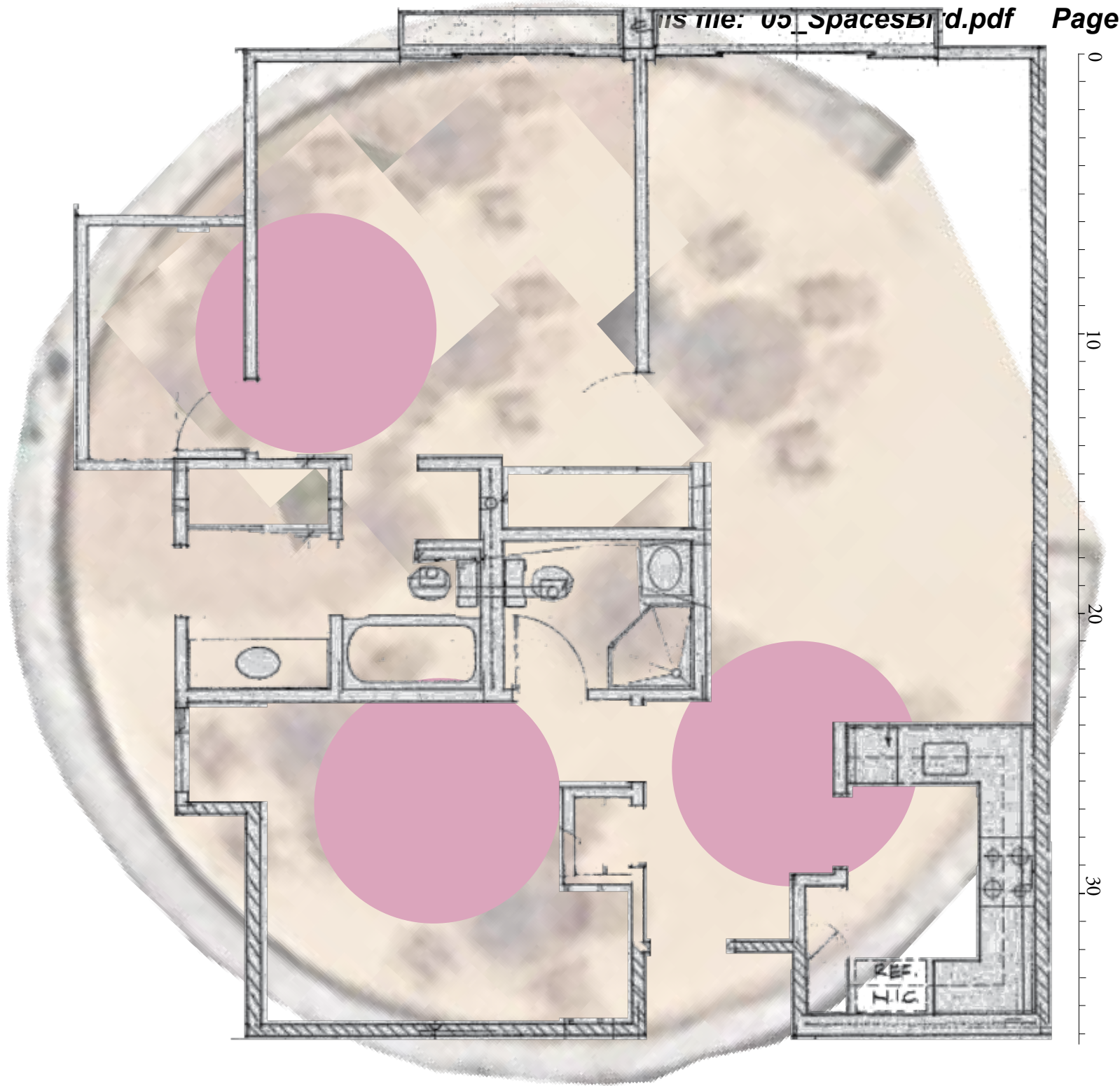

How big is 35 feet?

Here is the Commons Room lobby end, compared to the plaza

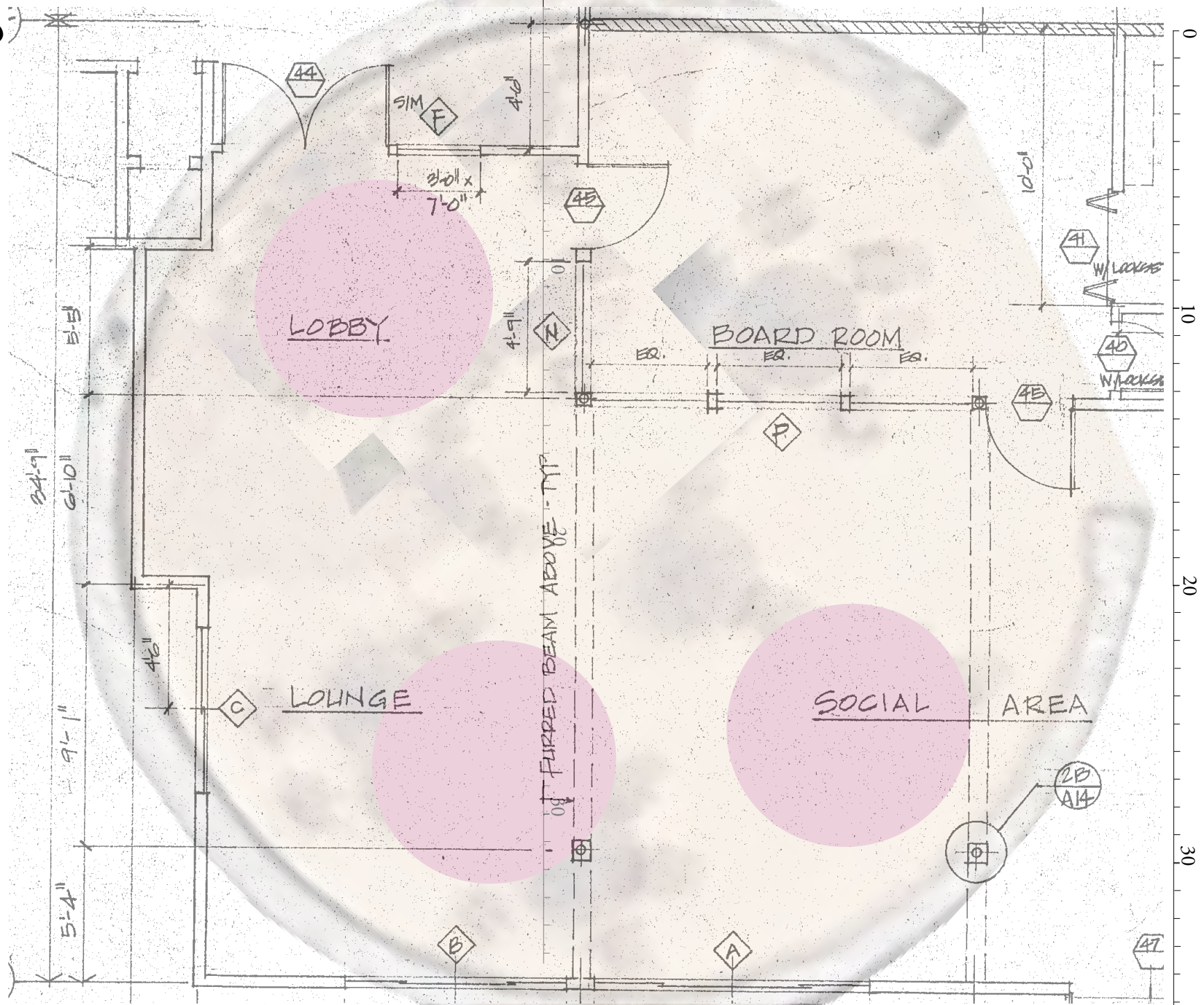

Perimeter path

The perimeter, too, holds opportunity for new spaces. Here, a 4' wide path is shown with several 12' round rest places with park benches. In one place, the path narrows to 32 inches to get past a tree.

Path is 300 m = 984 ft = 0.186 miles

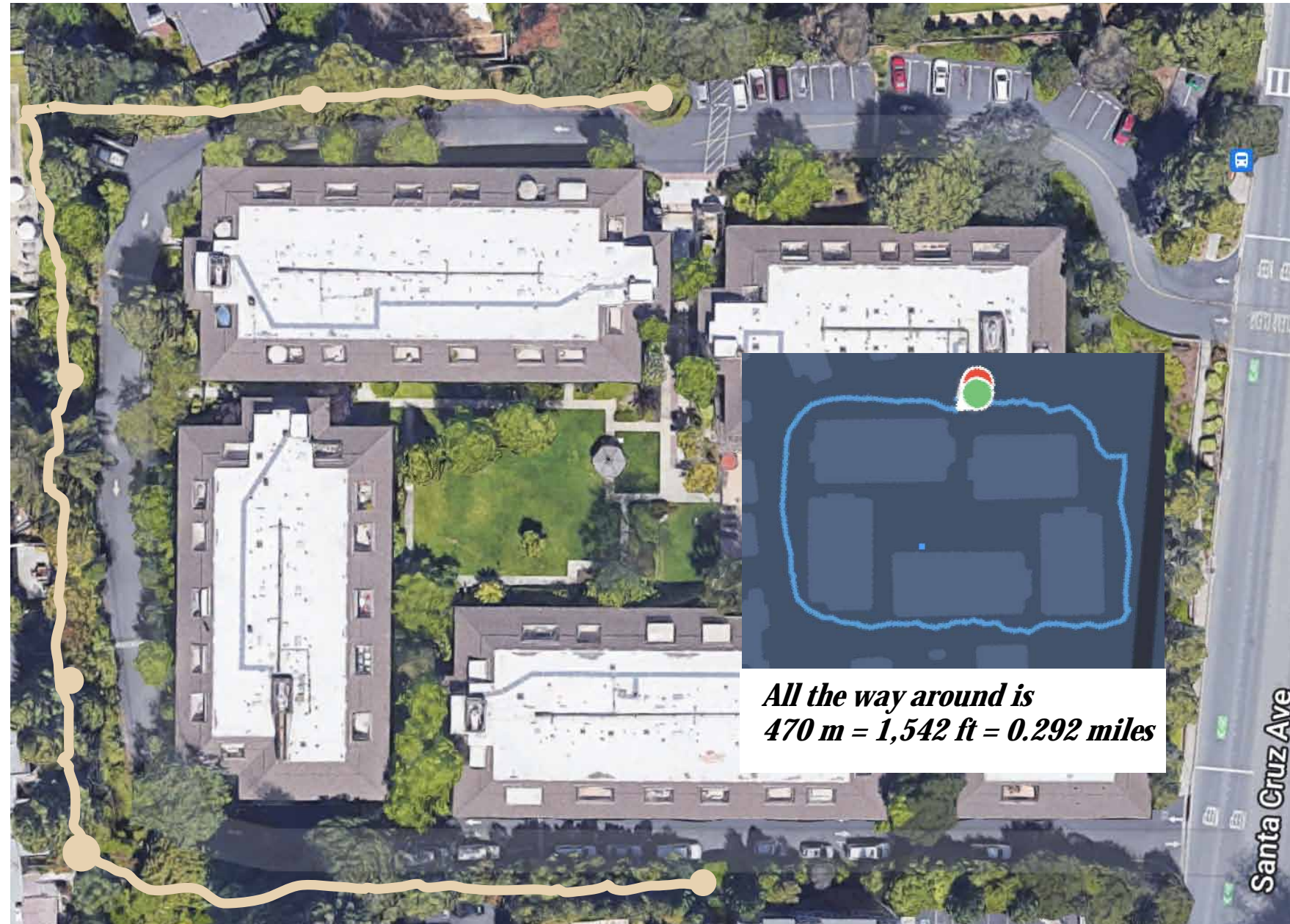
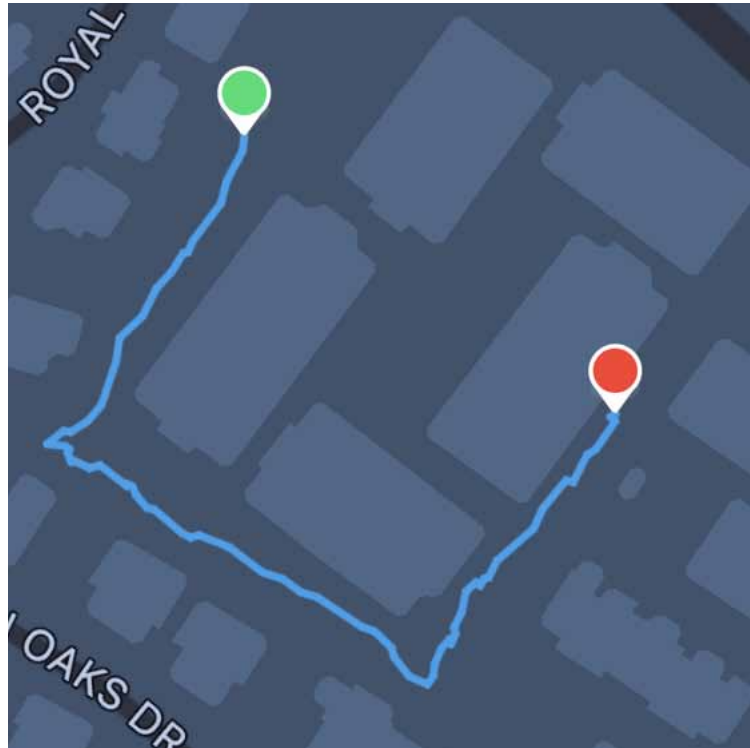

*All the way around is
470 m = 1,542 ft = 0.292 miles*

Criteria for landscape architect

Having thought about social spaces, this vision, at this stage, might result in criteria for a landscape architect something like this:

- o Create a drought-resistant park inside the five MC buildings***
- o Provide a substantial plaza for large gatherings and events***
- o Provide smaller spaces for small groups, spontaneous gatherings***
- o Provide walkways between plantings and social spaces***
- o Sculpt our terrain to create interesting topography. Sculpt to enhance privacy for residents concerned about people looking into their units.***
- o Create recreational spaces, such as for games***